



PRODUCT DIMENSIONS

MODEL 60520

TETSU 5' x 32"

MODEL 60540

TETSU 5-1/2' x 36"

MODEL 60560

TETSU 6' x 42"

MODEL 60580

TETSU OVAL

MODEL 60420

L'EXPRESSION 6'

MODEL 60070

CALLA OVAL

SPECIFICATIONS:

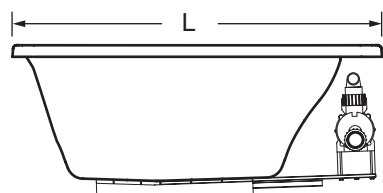

SIDE VIEW

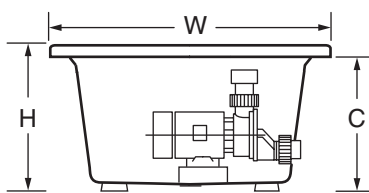

END VIEW

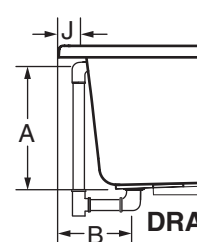

DRAIN / OVERFLOW

GENERAL SPECIFICATIONS

Description	Dimensions L-W-H	Drain / Overflow	Height to Underside of Deck: C	Cut Out Pier G x F	Rough-In Recess E x D	Tub Edge to Centerline Overflow: J	Weight with Water / Floor Loading	Product Weight	Gallon to Overflow	Whirlpool Operating Volume
60520 Tetsu 5' x 32"	L 60" (1524mm) W 32" (813mm) H 23" (584mm)	A 16-3/4" (425mm) B 10-1/4" (260mm)	C 20" (508mm)	58-1/2" (1486mm) x 30-1/2" (775mm)	60-3/16" (1529mm) x 30-1/2" (775mm)		597 lb. (271 kg)/ 45 lb./sq.ft. (219 kg/sq.m)	57 lb. (26 kg.)	54 gal. (246 l.)	
60540 Tetsu 5-1/2' x 36"	L 66" (1676mm) W 36" (914mm) H 23" (584mm)	A 16-7/8" (429mm) B 9-3/4" (248mm)	C 20" (508mm)	64-1/2" (1638mm) x 34-1/2" (876mm)	66-3/16" (1681mm) x 34-1/2" (876mm)		806 lb. (365 kg)/ 49 lb./sq.ft. (239 kg/sq.m)	65 lb. (29 kg.)	97 gal. (441 l.)	
60580 Tetsu Oval	L 68" (1727mm) W 38" (965mm) H 23" (584mm)	A 17-1/4" (438mm) B 11-1/2" (292mm)	C 20" (508mm)	Template Provided	68-3/16" (1732mm) x 36-1/2" (927mm)		680 lb. (308 kg)/ 68 lb./sq.ft. (331 kg/sq.m)	60 lb. (27 kg.)	90 gal. (409 l.)	
60560 Tetsu 6' x 42"	L 72" (1829mm) W 42" (1067mm) H 23" (584mm)	A 17" (432mm) B 10-1/4" (260mm)	C 20" (508mm)	70-1/2" (1791mm) x 40-1/2" (1029mm)	72-3/16" (1834mm) x 40-1/2" (1029mm)		1043 lb. (473 kg)/ 50 lb./sq.ft. (243 kg/sq.m)	68 lb. (31 kg.)	125 gal. (568 l.)	
60420 L'Expression 6' x 42"	L 72-1/8" (1832mm) W 32" (813mm) H 23" (584mm)	A 16" (406mm) B 7" (178mm)	C 21" (533mm)	Template Provided	72-5/16" (1837mm) x 30-1/2" (775mm)		605 lb. (272 kg)/ 32 lb./sq.ft. (154 kg/sq.m)	130 lb. (59 kg.)	57 gal. (216 l.)	38 gal. (144 l.)
60070 Calla Oval	L 69-1/2" (1765mm) W 34-3/4" (883mm) H 24" (635mm)	A 19" (483mm) B 9-3/4" (248mm)	C 22" (559mm)	Template Provided	As Desired		657 lb. (298 kg)/ 39 lb./sq.ft. (190 kg/sq.m)	107 lb. (49 kg.)	66 gal. (250 l.)	49 gal. (185 l.)

TABLE 1

ROUGH-IN REFERENCES

MODEL SERIES 60520

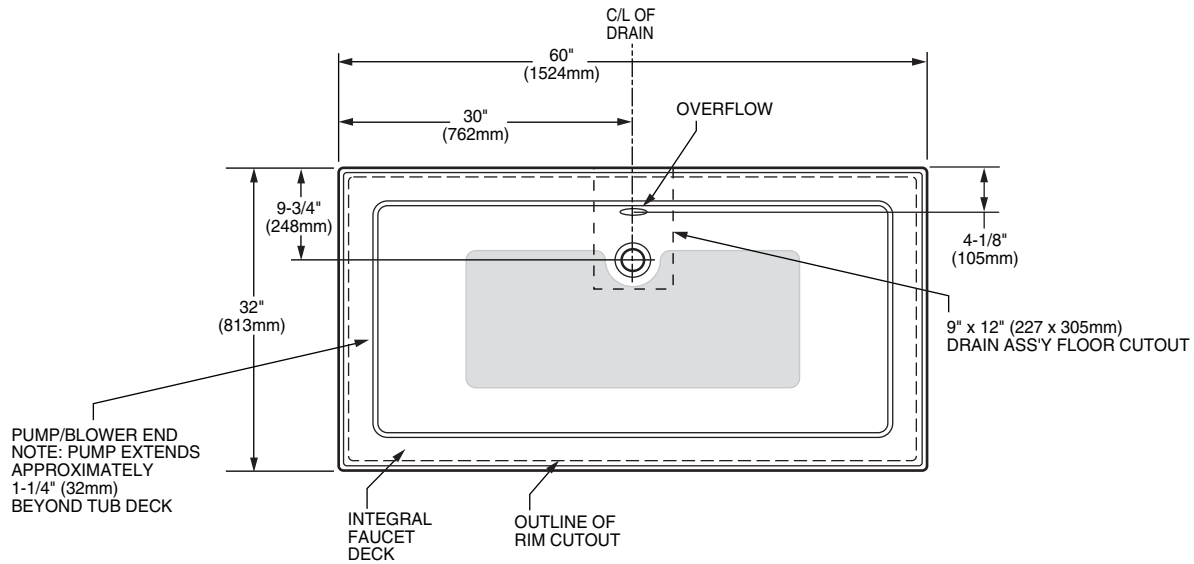

NOTE: PROVIDE ACCESS TO PUMP/BLOWER FOR SERVICE ON ALL INSTALLATIONS. SEE INSTALLATION AND FRAMING INSTRUCTIONS.

REVIEW DRAIN INSTALLATION DETAILS IN THIS DOCUMENT TO FULLY UNDERSTAND FLOOR CUTOUT REQUIREMENTS. AIR BATHS INCLUDE DRAIN. ALTERNATE DRAINS CANNOT BE USED ON AIR BATHS.

MODEL SERIES 60540

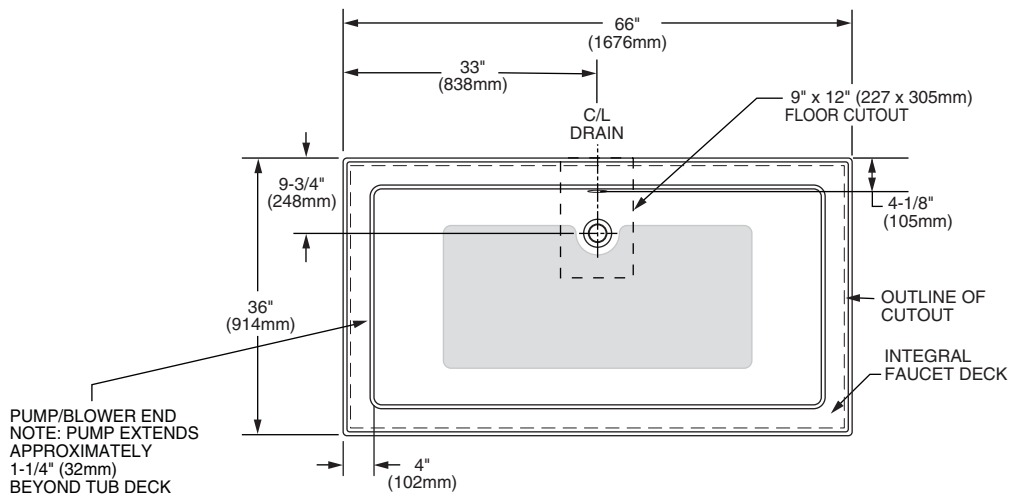

NOTE: PROVIDE ACCESS TO PUMP/BLOWER FOR SERVICE ON ALL INSTALLATIONS. SEE INSTALLATION AND FRAMING INSTRUCTIONS.

REVIEW DRAIN INSTALLATION DETAILS IN THIS DOCUMENT TO FULLY UNDERSTAND FLOOR CUTOUT REQUIREMENTS. AIR BATHS INCLUDE DRAIN. ALTERNATE DRAINS CANNOT BE USED ON AIR BATHS.

ROUGH-IN REFERENCES

MODEL SERIES 60580

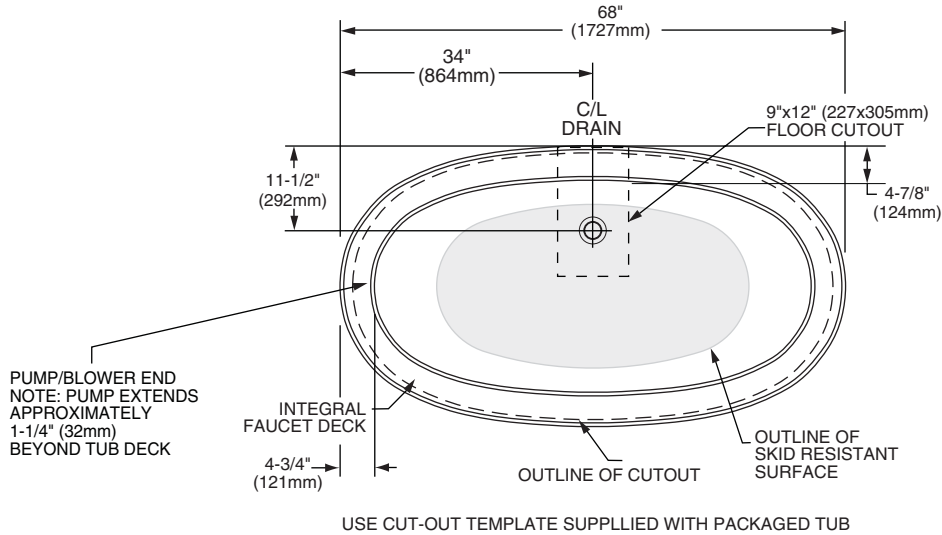

NOTE: PROVIDE ACCESS TO PUMP/BLOWER FOR SERVICE ON ALL INSTALLATIONS. SEE INSTALLATION AND FRAMING INSTRUCTIONS.

REVIEW DRAIN INSTALLATION DETAILS IN THIS DOCUMENT TO FULLY UNDERSTAND FLOOR CUTOUT REQUIREMENTS. AIR BATHS INCLUDE DRAIN. ALTERNATE DRAINS CANNOT BE USED ON AIR BATHS.

MODEL SERIES 60560

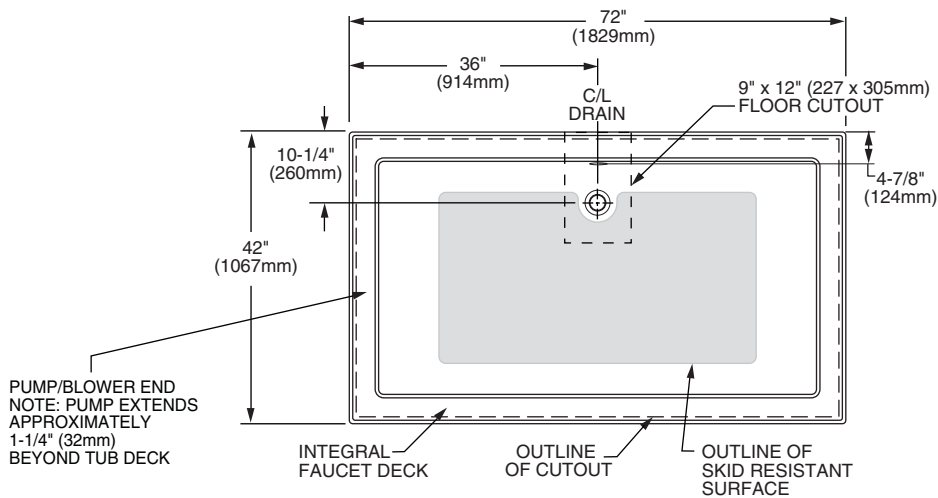

NOTE: PROVIDE ACCESS TO PUMP/BLOWER FOR SERVICE ON ALL INSTALLATIONS. SEE INSTALLATION AND FRAMING INSTRUCTIONS.

REVIEW DRAIN INSTALLATION DETAILS IN THIS DOCUMENT TO FULLY UNDERSTAND FLOOR CUTOUT REQUIREMENTS. AIR BATHS INCLUDE DRAIN. ALTERNATE DRAINS CANNOT BE USED ON AIR BATHS.

ROUGH-IN REFERENCES

MODEL SERIES 60420

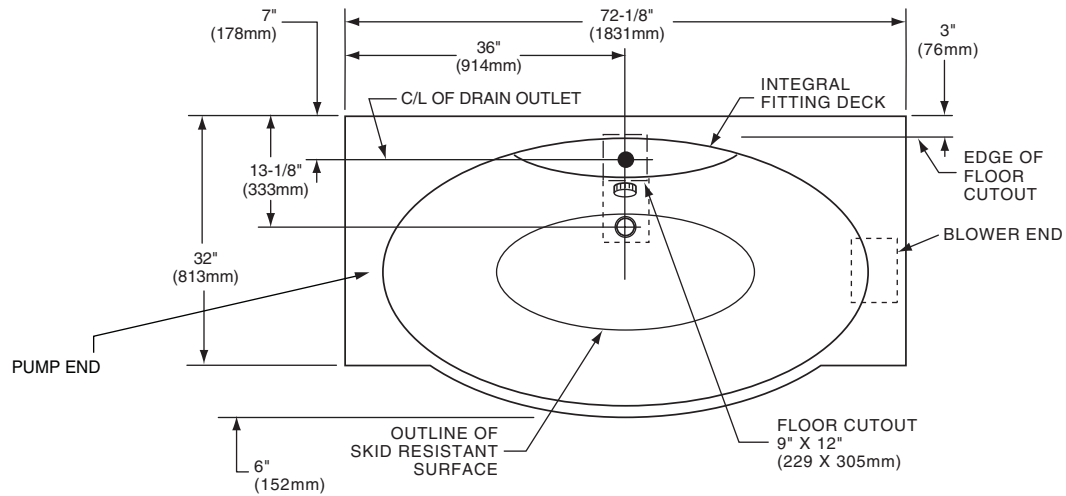

NOTE: PROVIDE ACCESS TO PUMP/BLOWER FOR SERVICE ON ALL INSTALLATIONS. SEE INSTALLATION AND FRAMING INSTRUCTIONS.

REVIEW DRAIN INSTALLATION DETAILS IN THIS DOCUMENT TO FULLY UNDERSTAND FLOOR CUTOUT REQUIREMENTS. AIR BATHS INCLUDE DRAIN. ALTERNATE DRAINS CANNOT BE USED ON AIR BATHS.

MODEL SERIES 60070

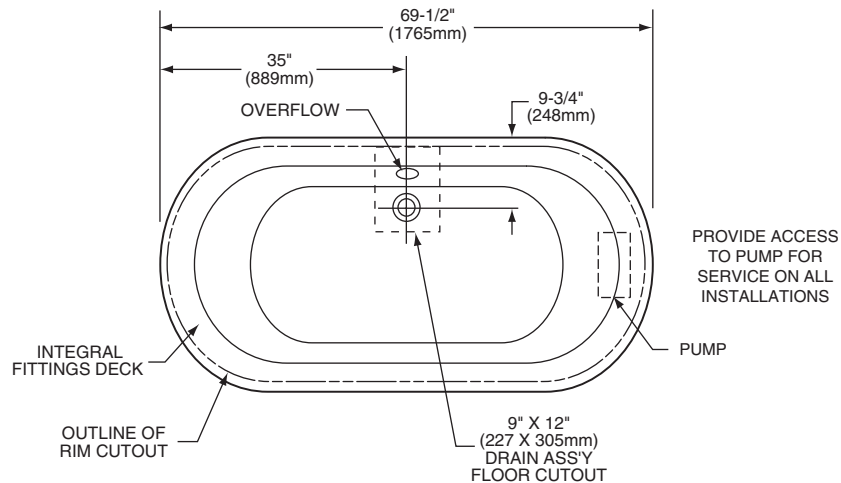

NOTE: PROVIDE ACCESS TO PUMP/BLOWER FOR SERVICE ON ALL INSTALLATIONS. SEE INSTALLATION AND FRAMING INSTRUCTIONS.

REVIEW DRAIN INSTALLATION DETAILS IN THIS DOCUMENT TO FULLY UNDERSTAND FLOOR CUTOUT REQUIREMENTS. AIR BATHS INCLUDE DRAIN. ALTERNATE DRAINS CANNOT BE USED ON AIR BATHS.